



#9GTA4

TOYOTA TUNDRA TRD PRO GEN 3
GRILLE BRACKET FOR 20" XTREME BAR



PART LIST

- A: 1x Left Front Plate
- B: 1x Right Front Plate
- C: 1x Left Back Plate
- D: 1x Right Back Plate
- E: 4x M6 Torx Head Screws
- F: 4x M6 Lock Washer

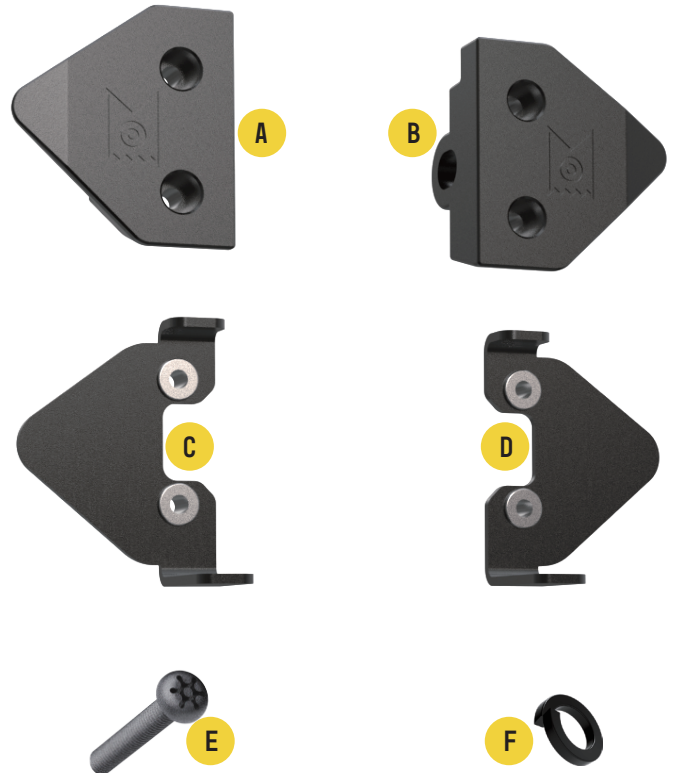

REQUIRED TOOLS

- Security Torx L-Key(Included)
- M6 Hex Wrench(Not included)



TECH NOTES

- No cutting or drilling is required for Tiny Monster Grille™ lights installation.
- Approximate install time: 20 minutes (not including harness installation)



STEP 1 – PLAN THE INSTALL

Unbox the grille brackets and lay out all of the components. Determine where you want to install the lights on the grille. The bracket installation location can refer to Figure 1.

(Figure 1)

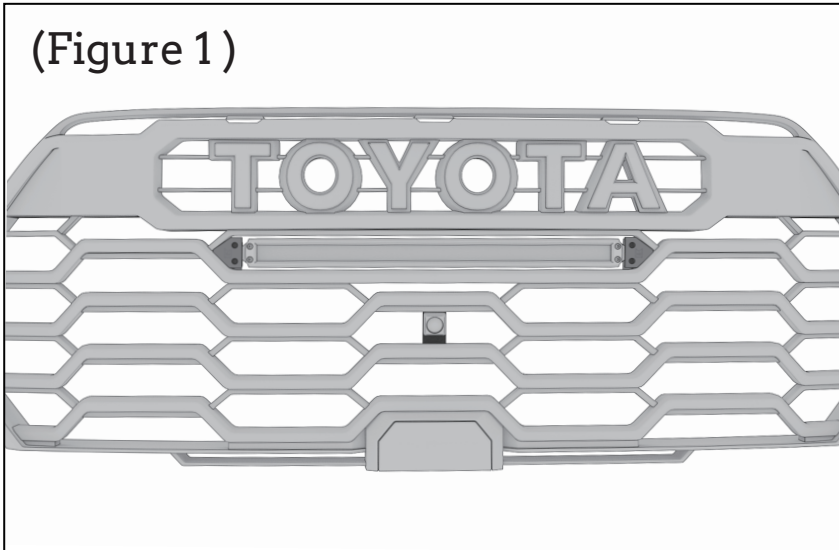

NOTES:

This bracket model fix to 20" xtreme bar, 64033. one kit can install to one(1) light bars.

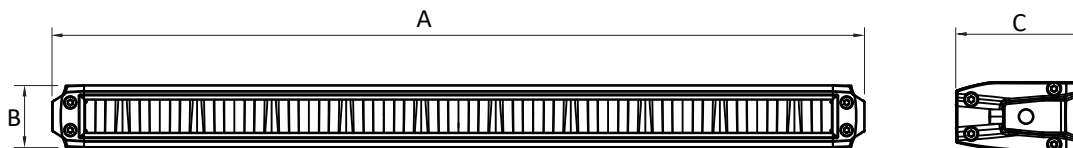

A: 20" B: 1-1/2" C: 2"
(Xtreme bar SKU #64033 sold separately)



STEP 2 – INSTALL THE GRILLE BRACKET + LIGHT

1. Join the light bar, left font plate, right front plate with two(2) M6 hex screws. (Figure 2)
2. Put the left back plate and right back plate behind the grille. (Figure 3)
3. Mount the light to the back plate with four(4) torx head screws. (Figure 4)

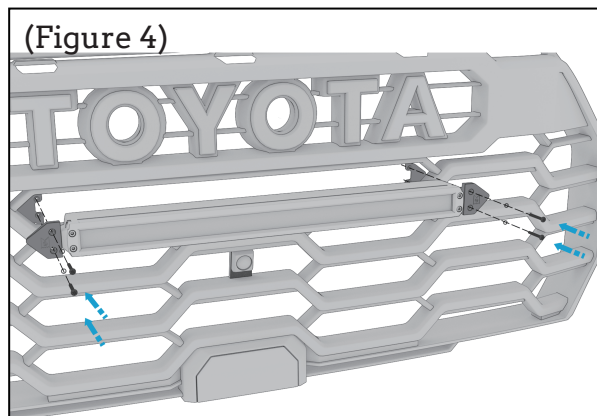
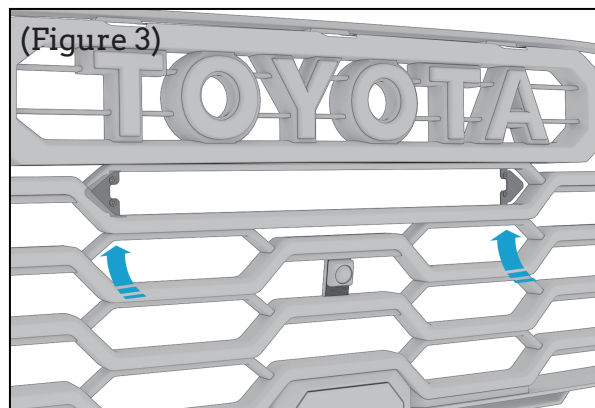
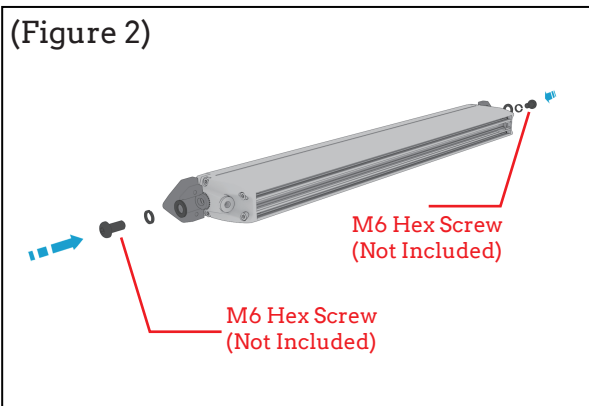

ARC LIGHTING
BASTROP, TEXAS 78602
UNITED STATES OF AMERICA
WWW.ARC.LIGHTING



⚠ WARNING: CANCER
AND REPRODUCTIVE HARM
WWW.P65WARNINGSCA.GOV