

SPECIFICATIONS:

- Light Output: 2,000 Lumens (per light)
- Power: 20W (per light)
- Voltage: 12-48V DC
- Beam: Driving
- Dual Beam: White driving beam and yellow wide beam
- Color Temperature: 3,000K / 6,000K
- Stainless steel side and bottom brackets
- Fitment: 2017-2020 Ford Raptor (Steel Bumper)

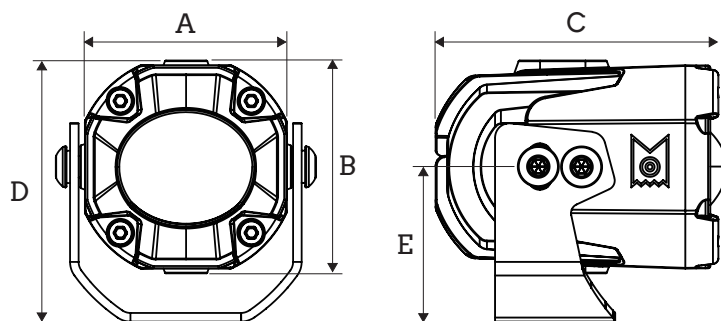

Lamp Dimension

A: 2" B: 2" C: 2-¹/₂"

D: 2-³/₈" E: 1-¹/₂"

INCLUDED:

- 6X LED pods
- 2X Triple Light Brackets (Assembled)
- 1X Wiring Harness
- 6X Extension Harness

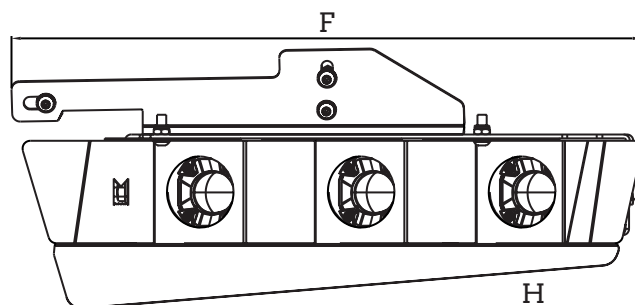

Bracket Dimension

F: 15-³/₄" G: 6-¹/₂"

H: 3-⁷/₈"

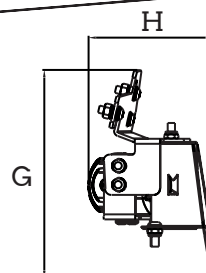

INSTALLATION:

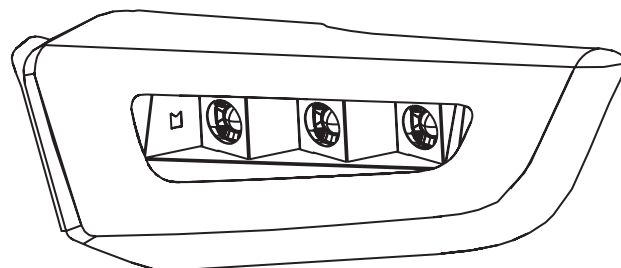
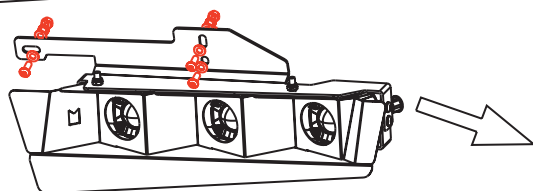
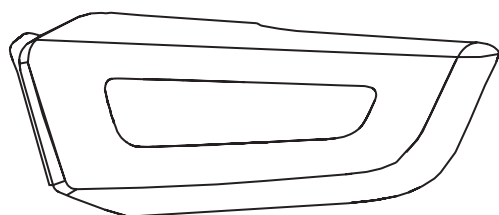

1. Loosen & remove bolts from your Bronco Bumper

Unscrew the bolts on both driver and passenger sides, 3 bolts each side, total 6 bolts.

2. Install brackets

Insert the appropriate-side brackets with lights, secure to the vehicle using the bolts removed earlier.

3. Route the wiring harness

Carefully route the wiring harness from the lights to the vehicle's battery. Avoid sharp edges, hot surfaces and moving parts that could damage the wiring.

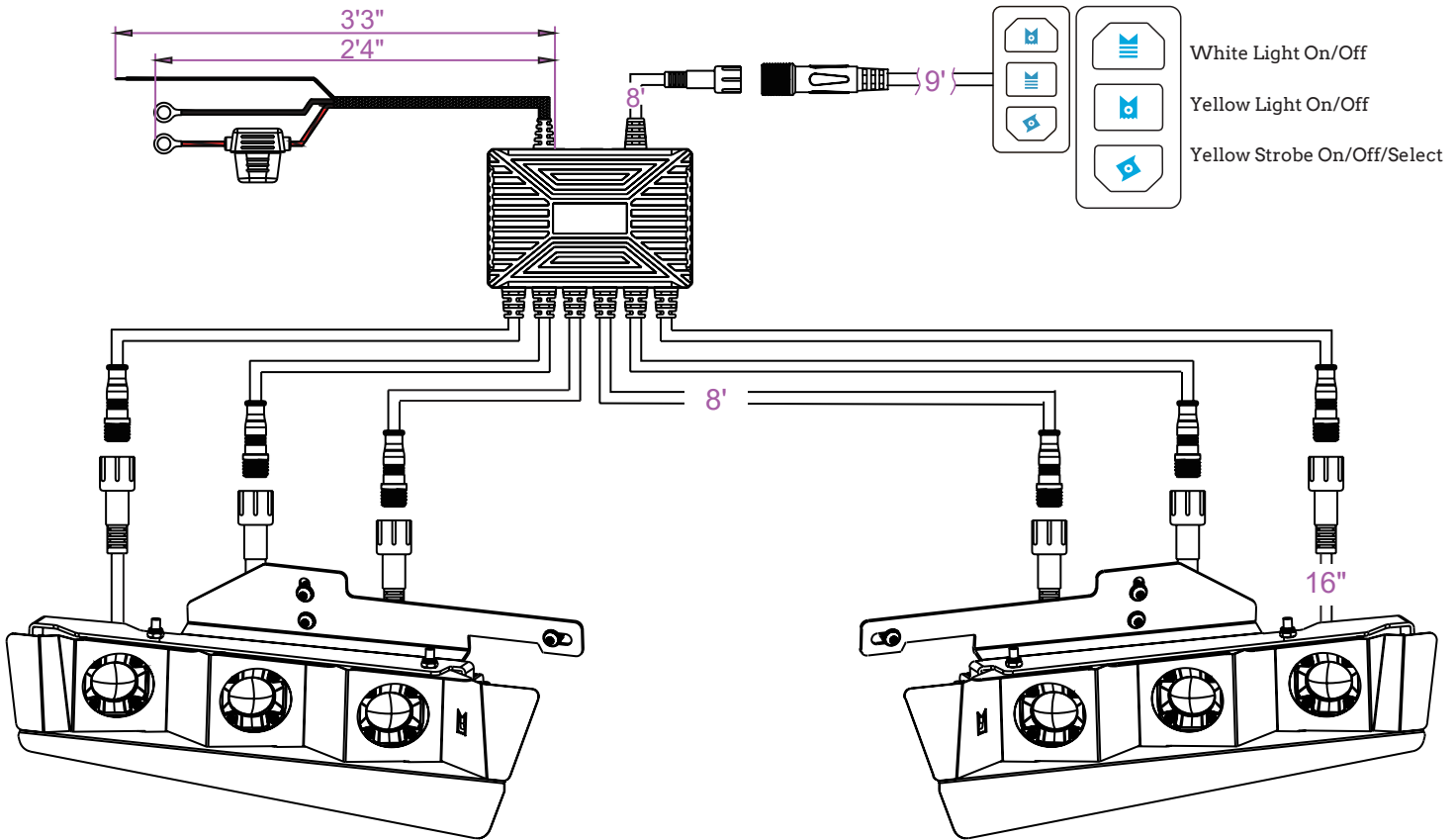

4. Connect the wiring harness

Connect the switch, smart wiring harness and the lights like photo shown above.

5. Secure the connections

Once all the connections are done, check and ensure they are securely fastened.

They come with a waterproof connector, so don't worry about short circuits or water leak.

6. Connect positive and negative wires properly

7. Test the lights:

Press the buttons to test if the lights are working properly.

8. How to control the lights with the switch?

- is a white high beam switch. Short press to turn the white light on or off. Long press to turn off all functions.
- is a yellow low beam switch. Short press to turn the yellow light on or off. Long press to turn off all functions.
- is a yellow strobe light switch. Short press to turn on, another short press to switch to the next mode.

Repeat in the following sequence:

Mode 1	Mode 2	Mode 3	Mode 4	Mode 5	Mode 6
DRL	Hyper burst	Rapid strobe	Slow strobe	Staggered Sequential Burst	Alternating Rapid Burst

Long press to turn off the strobe light.

Memory function: Pressing the buttons to turn on the light will recall last running mode.

9. Tips

- ① When the white high beam or yellow low beam is activated, turning on the strobe light will automatically deactivate the respective white high beam or yellow low beam, and vice versa.
- ② When white or yellow main beam light is on, turning on the other (yellow or white main beam) dims both lights by 50%. Turning off one light restores the other to full power, keeping their total power always the same.
- ③ If using auxiliary switches instead of the provided switch, connect the ACC wires to power to enable the corresponding functions.



ARC LIGHTING
BASTROP, TEXAS 78602
UNITED STATES OF AMERICA
WWW.ARC.LIGHTING



**WARNING: CANCER
AND REPRODUCTIVE HARM**
WWW.P65WARNINGS.CA.GOV