



SPECIFICATIONS:

6401D:

- Light Output: 1,800 Lumens (Per Light)
- Power: 20W (Per Light)
- Current: 1.5A @ 12V DC
- Voltage: 12-48V DC
- Dimension: 4" x 1-1/2" x 2-1/2"
- Beam Pattern: Driving Light

6401F:

- Light Output: 1,200 Lumens (White);
650 Lumens (Amber)
- Power: 20W (Per Light)
- Current: 1.5A @ 12V DC
- Voltage: 12-48V DC
- Dimension: 4" x 1-1/2" x 2-1/2"
- Beam Pattern: Fog Light

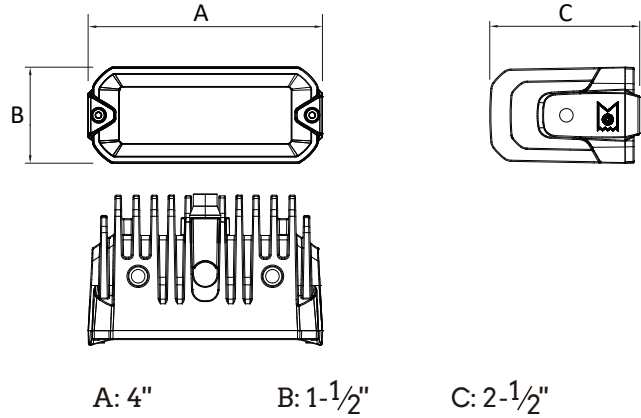

INCLUDED:

- 2x LED Light Bars
- 4x Side mount brackets
- 2x DT Pigtail Connector
- Mounting Hardware



WIRING:

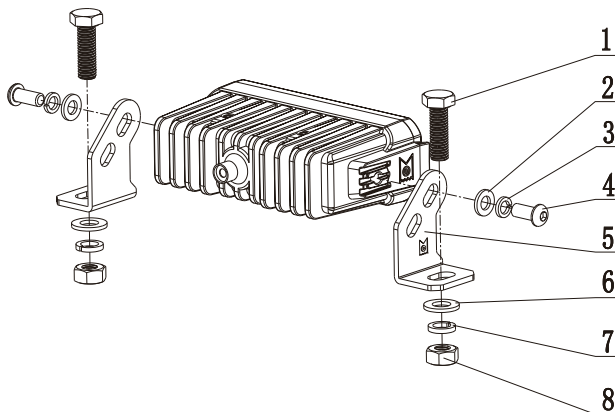

1	2	3	4
5	6	7	8

Figure 1

Note:

The Xtreme Bar #6401D and #6401F is one of the light modules in the Tiny Monster Grille product line. A vehicle-specific mounting bracket is required to integrate these light modules into the factory grille. Please refer to the installation manual of the mounting brackets for detailed instructions: www.arc.lighting/tiny-monster-grille



When installing the 6401D, connect the light's red and black wires.
When installing the 6401F, connect the light's red, black, and yellow wires.

- | | | | | | |
|--------|-------------|--------------|-------------|----------------------------|-------------------------|
| Mode 1 | 2 | 3 | 4 | 5 | 6 |
| DRL | Hyper burst | Rapid strobe | Slow strobe | Staggered Sequential Burst | Alternating Rapid Burst |

Tips:

- 

**⚠ WARNING: CANCER
AND REPRODUCTIVE HARM
WWW.P65WARNINGSCA.GOV**