



SPECIFICATIONS:

6402D/6402DT:

- Light Output: 3,400 Lumens (Per Light)
- Power: 45W (Per Light)
- Current: 5A @ 12V DC
- Voltage: 10-48V DC
- Dimension: 7" x 1-1/2" x 2-1/2"
- LED Color: White
- Beam Pattern: Driving Light

6402YT:

- Light Output: 3,400 Lumens (Per Light)
- Power: 45W (Per Light)
- Current: 5A @ 12V DC
- Voltage: 10-48V DC
- Dimension: 7" x 1-1/2" x 2-1/2"
- LED Color: Yellow
- Beam Pattern: Driving Light

6402D:

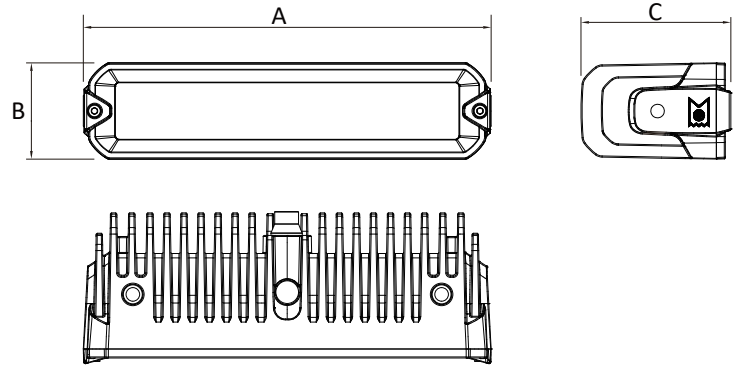

A: 7"

B: 1-1/2"

C: 2-1/2"

6402DT/6402YT:

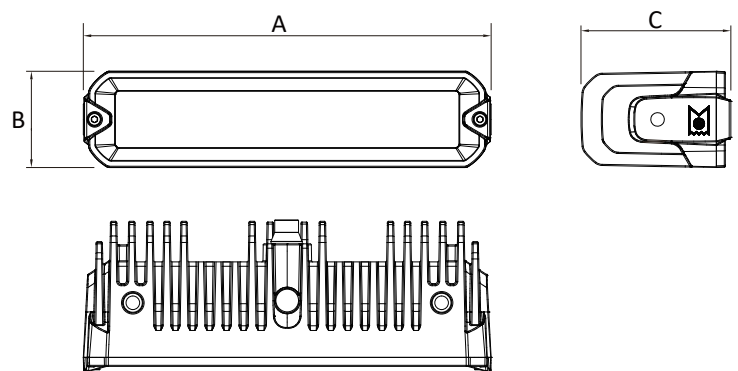

A: 7"

B: 1-1/2"

C: 2-1/2"



INCLUDED:

- 2x LED Light Bars
- 4x Side mount brackets
- 2x DT Pigtail Connector
- Mounting Hardware



WIRING:

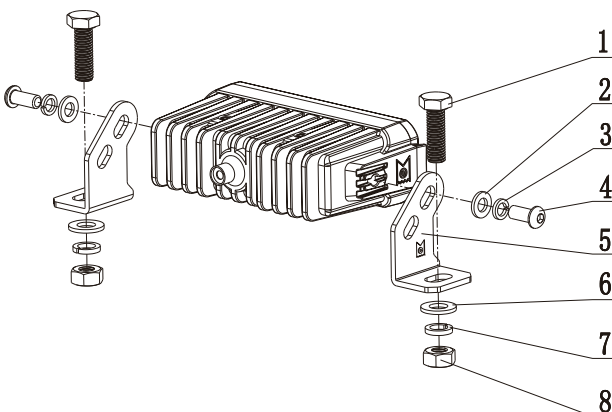

1	2	3	4
5	6	7	8

Figure 1

Note:

The Xtreme Bar #6402D/6402DT/6402YT is one of the light modules in the Tiny Monster Grille product line. A vehicle-specific mounting bracket is required to integrate these light modules into the factory grille. Please refer to the installation manual of the mounting brackets for detailed instructions: www.arc.lighting/tiny-monster-grille



INSTALLATION INSTRUCTIONS

XTREME BAR #6402D/6402DT/6402YT

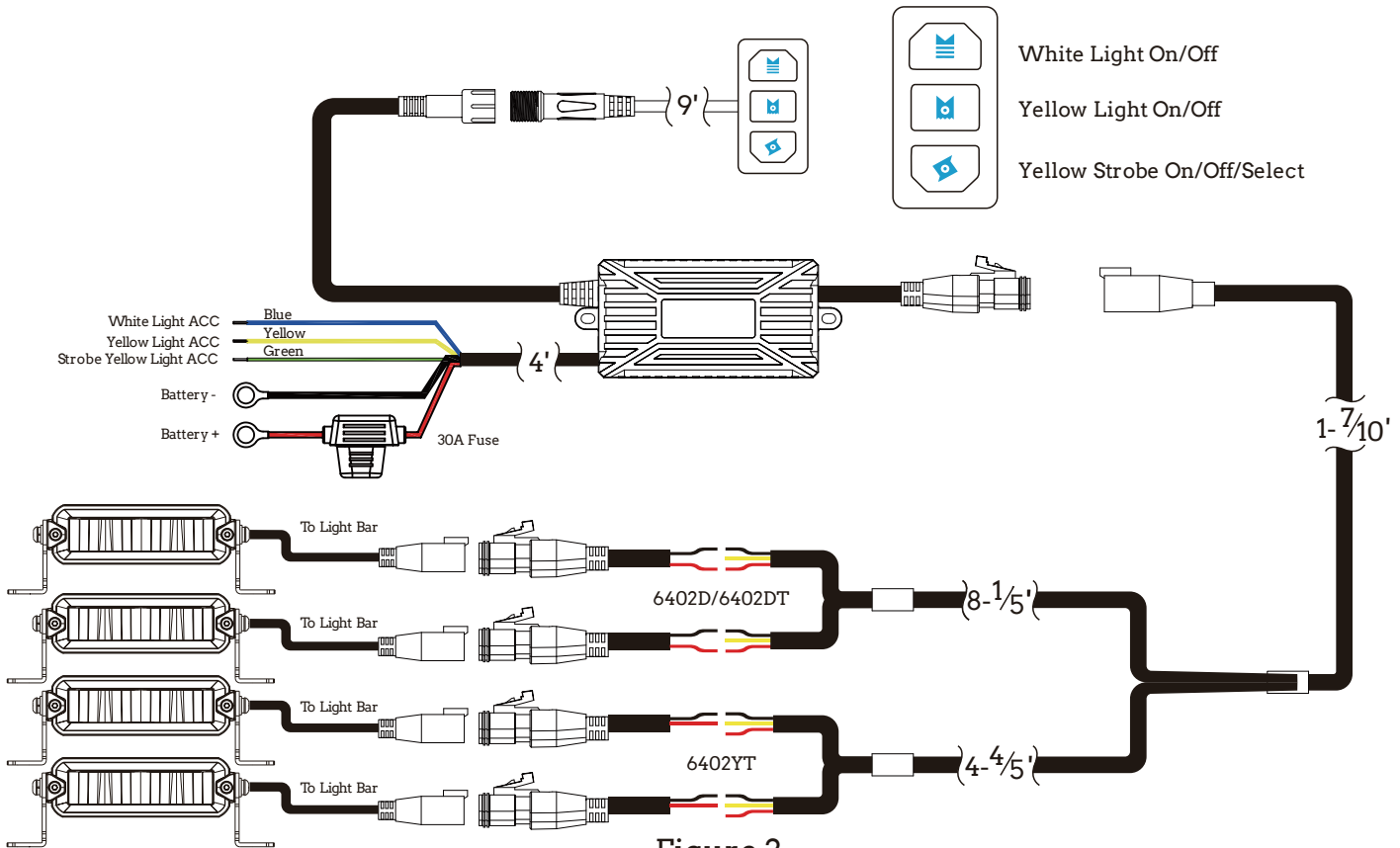

Figure 2

(Harness SKU #84024 sold separately)

When installing the 6402D/6402DT, connect the light's red and black wires to the harness red and black wires respectively.
When installing the 640YT, connect the light's red and black wires to the harness yellow and black wires instead.

Only available in 6402D/6402DT:

1. The white light switch. Press less than 1 second to turn the white light on or off. Press and hold to turn off the white light.

Only available in 6402YT:

2. The yellow light switch. Press less than 1 second to turn the white light on or off. Press and hold to turn off the yellow light.
3. The yellow strobe light switch. Press less than 1 second to turn the strobe light on, and press it again to switch to the next mode. Press and hold to turn off the strobe light. The sequence of modes is as follows:

Mode 1	2	3	4	5	6
DRL	Hyper burst	Rapid strobe	Slow strobe	Staggered Sequential Burst	Alternating Rapid Burst

Memory function: When turning on the light, the last used mode will be recalled.

Tips:

- ① When the white light or yellow light is activated, turning on the strobe light will automatically deactivate the respective white light or yellow light.
- ② When white or yellow main light is on, turning on the other (yellow or white main light) dims both lights by 50%. Turning off one light restores the other to full power.
- ③ If using auxiliary switches instead of the provided switch, connect the ACC wires to power to enable the corresponding functions. (see Figure 2)



ARC LIGHTING
BASTROP, TEXAS 78602
UNITED STATES OF AMERICA
WWW.ARC.LIGHTING



**⚠ WARNING: CANCER
AND REPRODUCTIVE HARM
WWW.P65WARNINGSCA.GOV**